

ROOF RESTORATION
WINNEBAGO COUNTY BID #21B-2231

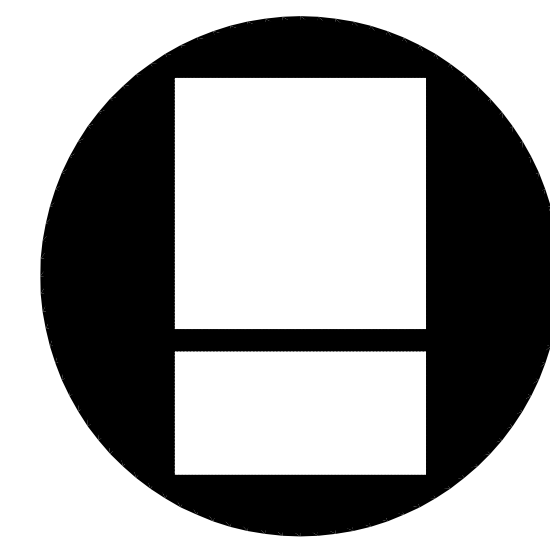

WINNEBAGO
COUNTY
COURTHOUSE
ROCKFORD, IL 61101
400 W. STATE STREET



Larson & Darby Group
Architecture Engineering Interiors
4949 Harrison Avenue Suite 100 Rockford, Illinois

ISSUED FOR: BIDDING/ CONSTRUCTION

SEPTEMBER 24, 2021

PROPOSED CRANE LOCATION MAP

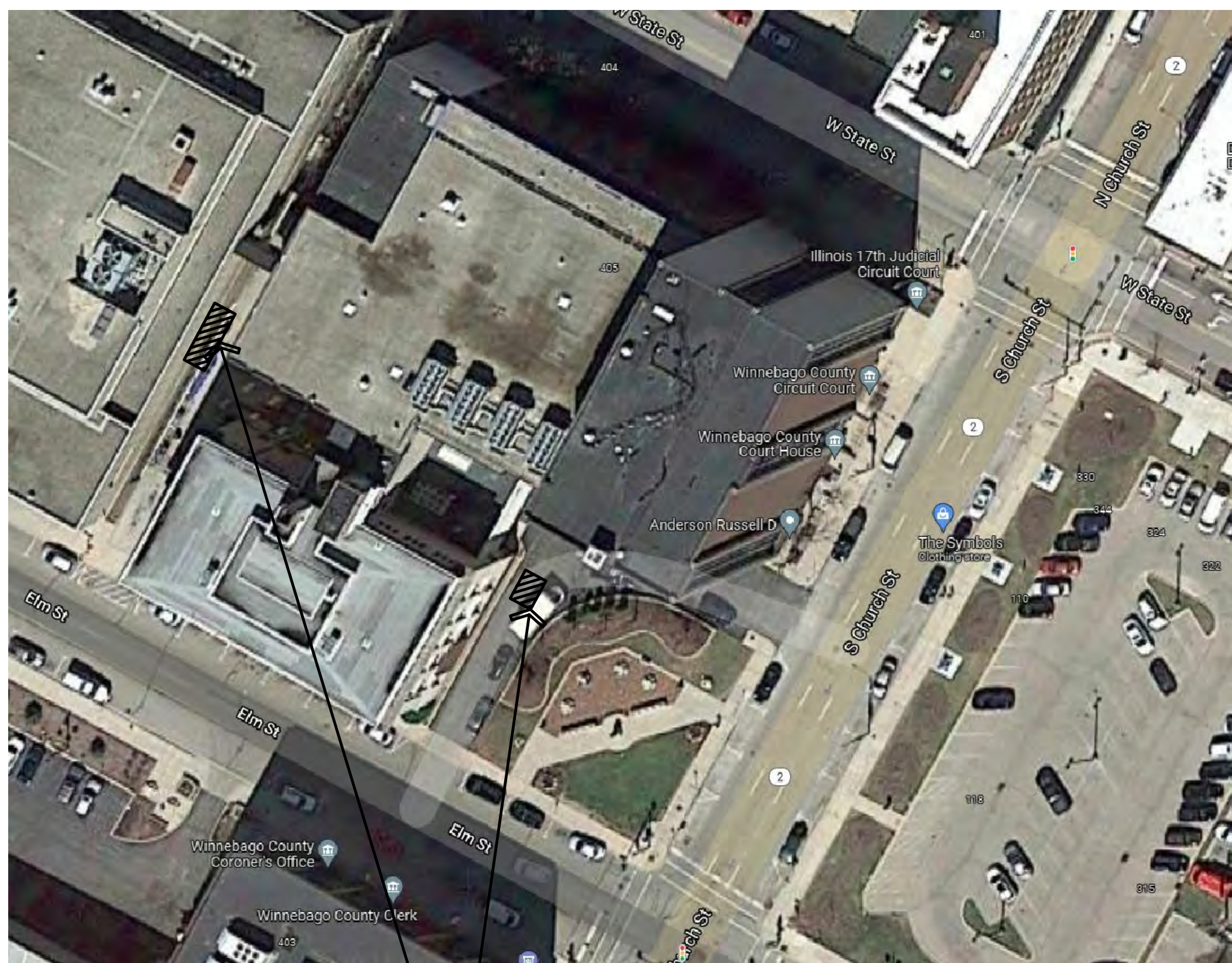

PROPOSED CRANE
LOCATIONS (VERIFY
WITH OWNER)

LOCATION MAP

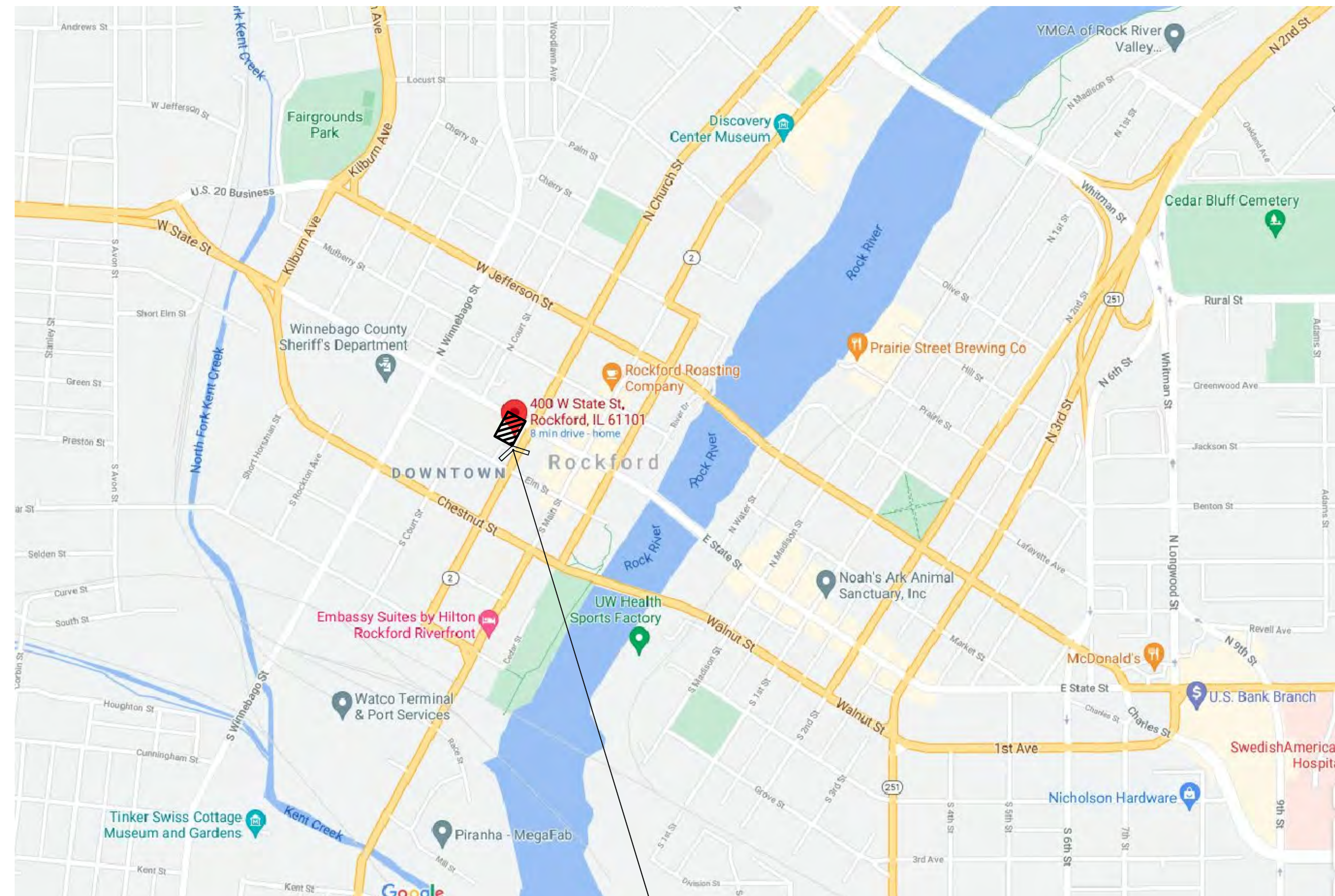

PROJECT LOCATION

SHEET INDEX

NO. DESCRIPTION

ARCHITECTURAL

- TL1 TITLE SHEET & LOCATION MAPS
- A0.1 EXISTING CONDITIONS PHOTOGRAPHS
- A1.1 ROOF PLAN - DEMOLITION AND NOTES
- A1.2 ROOF PLAN - NEW WORK AND NOTES
- A1.3 ROOF DETAILS

GENERAL

CODE COMPLIANCE NOTES

Building Code: 2015 International Existing Building Code
Plumbing Code: 2014 Illinois Plumbing Code

REGISTRATION NUMBER & SEAL

Larson & Darby Group Design Firm Registration Number: 184-000280



EXPIRES: 11-30-2022

GEODEON L. TRIAS
LICENSED ARCHITECT

9-21-2021
DATE

Larson & Darby Group
Architecture Engineering Interiors
4949 Harrison Avenue, Suite 100, Rockford, IL 61108 Tel (815) 484-0739 Fax (815) 229-9867

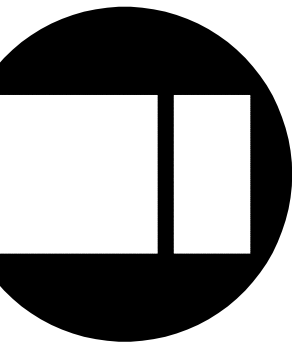

ROOF RESTORATION
WINNEBAGO COUNTY COURTHOUSE
400 W. STATE STREET, ROCKFORD, ILLINOIS

COPYRIGHT 2021
All drawn and written information
appearing herein shall not be
reproduced, copied, or otherwise
used without the written consent of
Larson & Darby Group

ISSUED FOR: DATE
DRAWN APPROVED
JSM GT

DATE: 9-24-2021
PROJECT NUMBER
31126
SHEET NUMBER
CS



① ROOF TOP UNITS OVERALL



② PIPE CURBS IN BETWEEN RTU'S



③ EXHAUST FAN



④ CAPPED ROOF CURB & SKYLIGHT



⑤ SOUTH LADDER ACCESS



⑥ EXHAUST FAN ALONG PARAPET



⑦ PARAPET CONDITION



⑧ NORTH LADDER ACCESS



⑨ EXHAUST FAN



⑩ NORTH CORNER OF ROOF



⑪ EXHAUST FANS



⑫ ROOF SAFETY RAILING



⑬ ROOF SAFETY RAIL



⑭ ROOF DRAIN



⑮ PLUMBING VENT



⑯ PLUMBING VENT

PHOTOGRAPHS OF EXISTING CONDITIONS
SCALE: NTS

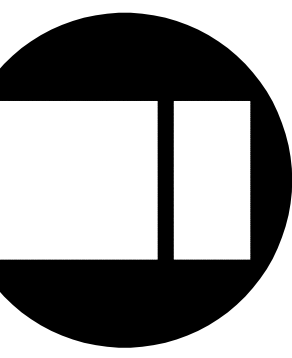

COPYRIGHT 2021
All drawn and written information
appearing herein shall not be
reproduced, copied, or otherwise
used without the written consent of
Larson & Darby Group.

ISSUED FOR:	DATE
DRAWN	APPROVED
JSM	GT

DATE: 9-24-2021
PROJECT NUMBER
31126
SHEET NUMBER
A0.1



Please Note: Core information is for reference only. It may not accurately represent the construction of the entire roof.



Please Note: Core information is for reference only. It may not accurately represent the construction of the entire roof.

2 EXISTING ROOF CONSTRUCTION

SCALE: _____ N.T.S.

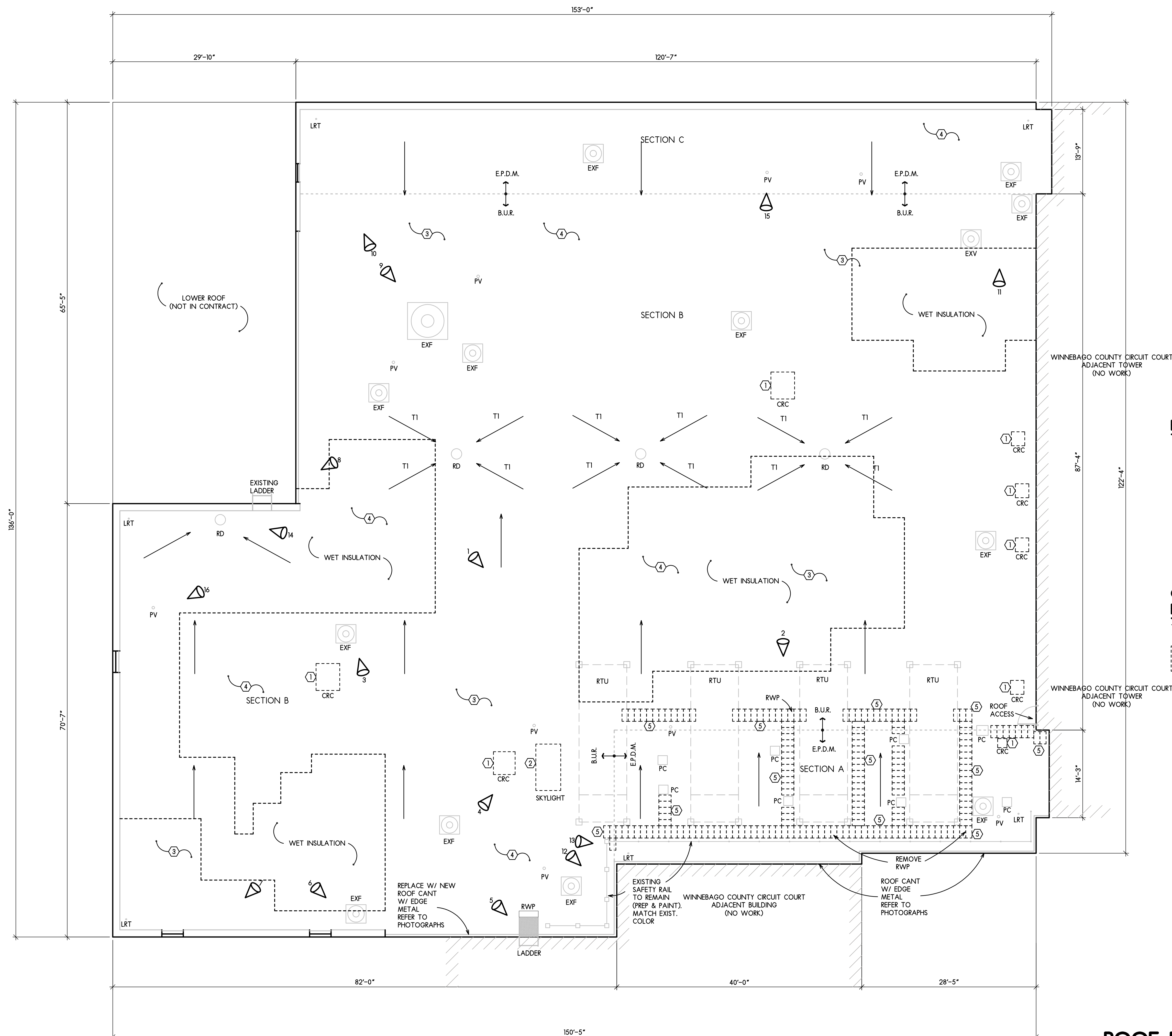

① ROOF PLAN - DEMOLITION

SCALE: $1/8" = 1'-0"$

ARCHITECTURAL SYMBOLS:



SECTION A, B & C

THESE ARE MARKED ON
THE PLAN IN REFERENCE
TO THE TREMCO REPORT
INCLUDED IN
SPECIFICATION FOR
REFERENCE ONLY.

TOTAL PERIMETER = 580' +/-
TOTAL AREA = 17,250 Sq Ft. +/-

TOTAL ROOF PENETRATIONS (VERIFY IN FIELD)

EXHAUST VENT - 14
PLUMBING VENT - 9
ROOF DRAIN (SEE DETAIL) - 4
ROOF TOP UNIT - 4
SKYLIGHT (SEE DETAIL) - 1
LIGHTNING ROD GROUND WIRE
CONDUIT ROOF PENETRATION - 5
*CAPPED ROOF CURB - 8
PIPE CURB - 8

ROOFING WORK SCOPE:

1. REMOVE EXISTING ROOF BALLAST.
2. REPLACE ALL WET INSULATION. ALL OTHER INSULATION IS TO REMAIN IN PLACE.
3. IF ROOF DRAINS ARE DAMAGED, REPAIR OR REPLACE WITH NEW AND HAVE ALL ROOF DRAINS ADJUSTED FOR NEW ROOFING SYSTEM.
4. REMOVE ALL CAPPED ROOF CURBS (CRC). PROVIDE ROOF DECKING TO MATCH ADJACENT, PROVIDE INSULATION TO MATCH ADJACENT. PROVIDE NEW ROOFING SYSTEM PER SPECIFICATIONS.
5. REMOVE ALL METAL WALL COPINGS/METAL FASCIA/ CANT EDGES AND GRAVEL STOPS. REPLACE ALL METAL WITH NEW. CONTRACTOR SHALL VERIFY SIZES AND QUANTITIES.
6. INSTALL FLUID APPLIED ROOFING SYSTEM PER MANUFACTURER'S RECOMMENDATIONS.

ROOFING DEMOLITION KEY NOTES:

- ① CAPPED ROOF CURBS (CRC) - REMOVE CAP, AND ROOF CURBS DOWN TO DECK, INFILL WITH LIKE MATERIAL, INSTALL NEW INSULATION TO MATCH ADJACENT AND PROVIDE NEW ROOF SYSTEM OVER THIS AREA.
- ② REMOVE SKYLIGHT AND PREP OPENING FOR NEW CURBS, FLASHING AND SKYLIGHT UNIT (SEE SPECIFICATION)
- ③ REPLACE ALL WET OR DAMAGED INSULATION. ALL OTHER INSULATION IS TO REMAIN IN PLACE.
- ④ REMOVE ENTIRE EXISTING LIGHTNING PROTECTION SYSTEM ON THIS ROOF ONLY, INCLUDING ALL TERMINALS, CABLEING, AND SUPPORTS.
- ⑤ REMOVE AND DISCARD ALL ROOF WALKWAY PAVERS (RWP).

GENERAL DEMOLITION
ROOFING NOTES:

1. FOR ROOF AREAS WHERE SLOPE IS PROVIDED BY THE ROOF STRUCTURE, TYPICAL INSULATION THICKNESS IS 3" THROUGHOUT.
- AREAS OF WET INSULATION FROM TREMCO REPORT INCLUDED FOR REFERENCE ONLY IN SPECIFICATION

ABBREVIATIONS:

EXF - EXHAUST FAN
PV - PLUMBING VENT
RD - ROOF DRAIN (SEE DETAIL)
RTU - ROOF TOP UNIT
SKY - SKYLIGHT (SEE DETAIL)
LRT - LIGHTNING ROD TERMINAL
WIRE CONDUIT ROOF PENETRATION
CRC - CAPPED ROOF CURB
PC - PIPE CURB
RWP - ROOF WALKWAY PAVERS

ROOF PLAN - DEMOLITION, NOTES & DETAILS

SCALE: _____ AS NOTED

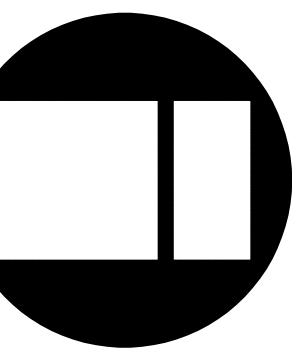
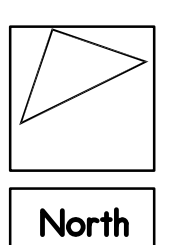

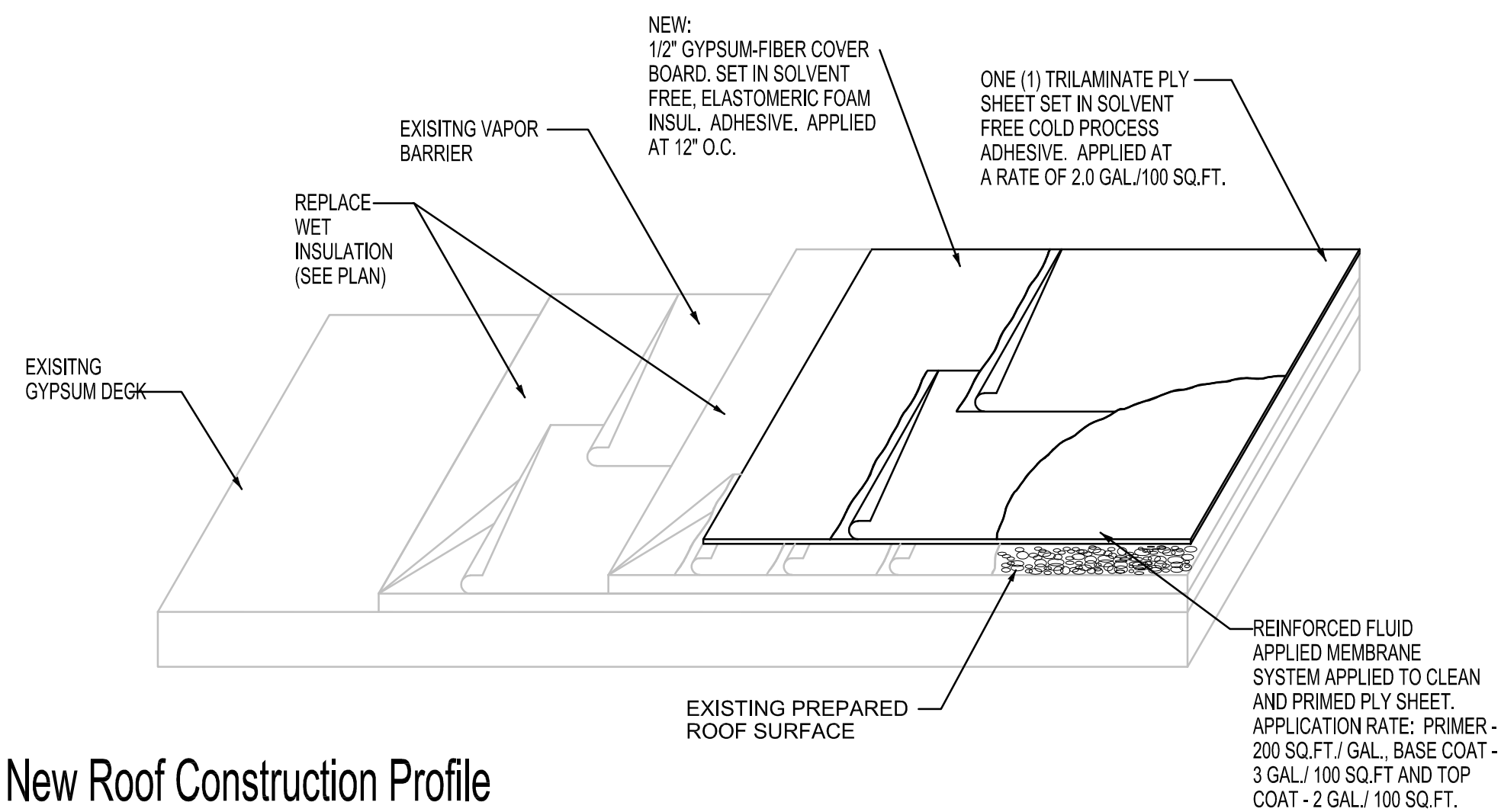

New Roof Construction Profile
@ Existing B.U.R. Section
(SECTION B) SEE PLAN

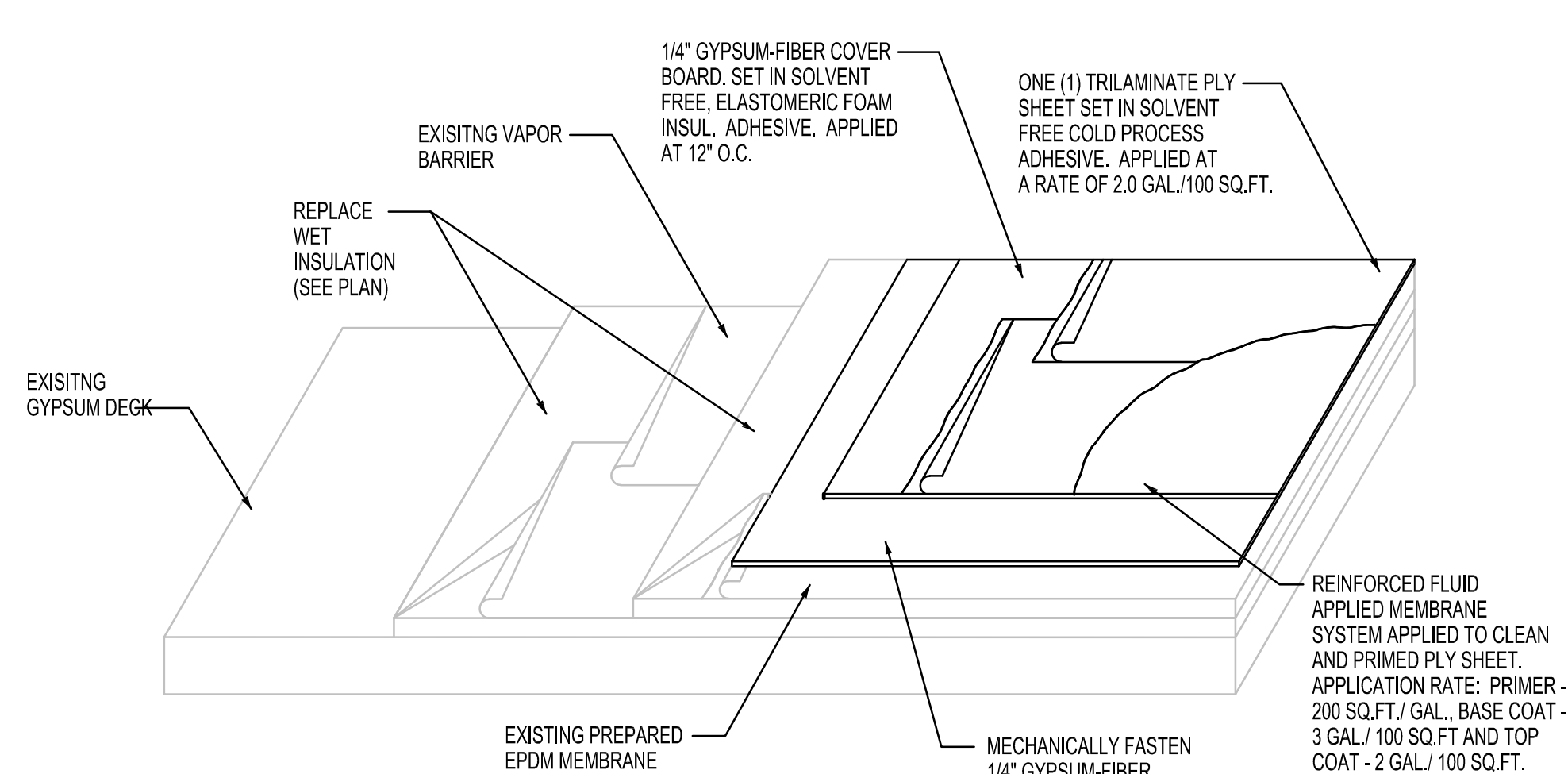

New Roof Construction Profile
@ Existing Ballasted E.P.D.M. Section
(SECTIONS A & C) SEE PLAN

2 REVISED ROOF CONSTRUCTION
SCALE: N.T.S.

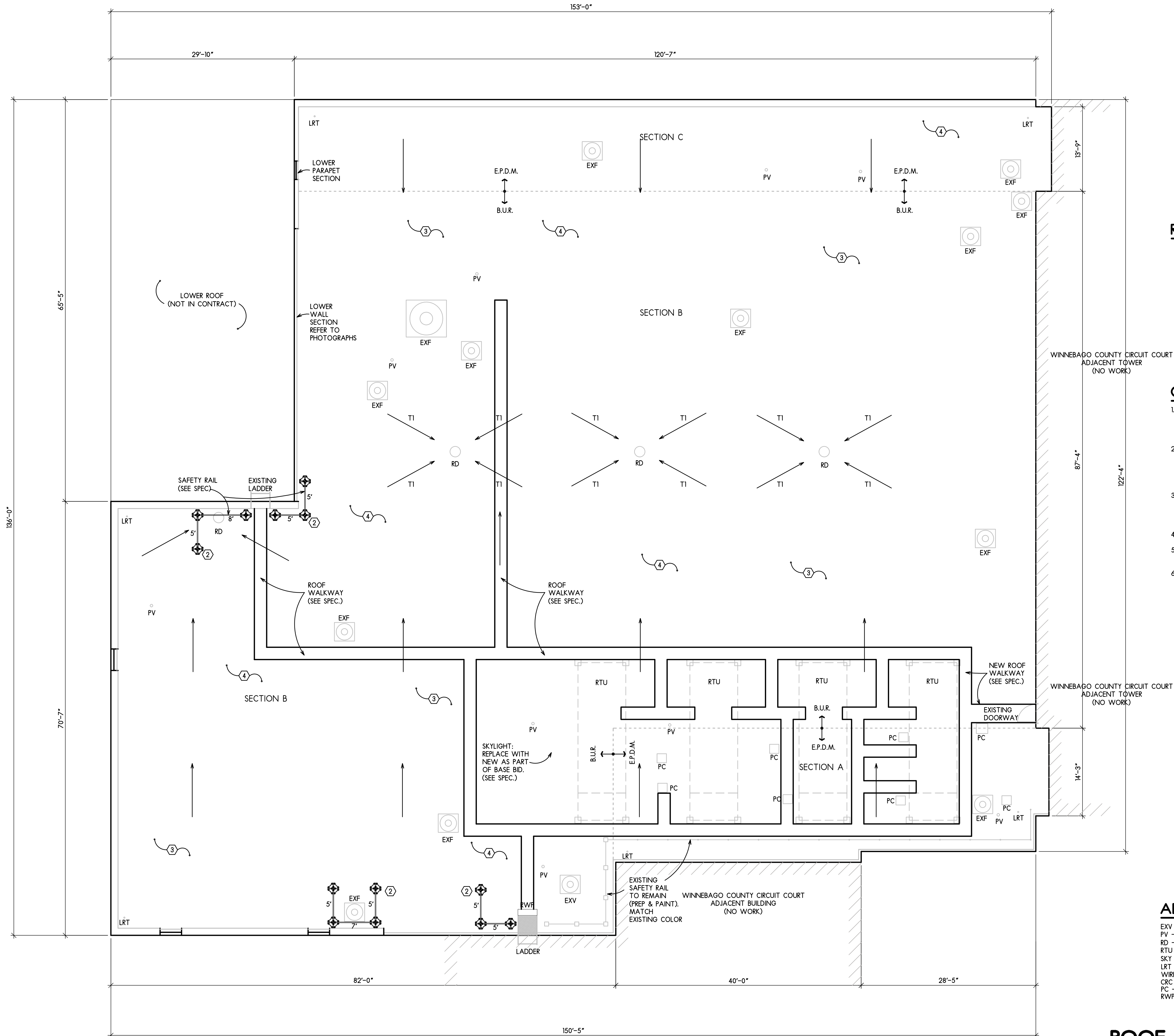

1 ROOF PLAN - REVISED
SCALE: 1/8\"/>

ARCHITECTURAL SYMBOLS:

SECTION A, B & C THESE ARE MARKED ON THE PLAN IN REFERENCE TO THE TREMCO REPORT INCLUDED IN SPECIFICATION FOR REFERENCE ONLY.

ROOFING WORK SCOPE:

1. REMOVE EXISTING ROOF BALLAST.
2. REPLACE ALL WET INSULATION. ALL OTHER INSULATION IS TO REMAIN IN PLACE.
3. IF ROOF DRAINS ARE DAMAGED, REPAIR OR REPLACE WITH NEW AND HAVE ALL ROOF DRAINS ADJUSTED FOR NEW ROOFING SYSTEM.
4. REMOVE ALL CAPPED ROOF CURBS (CRC). PROVIDE ROOF DECKING TO MATCH ADJACENT, PROVIDE INSULATION TO MATCH ADJACENT, PROVIDE NEW ROOFING SYSTEM PER SPECIFICATIONS.
5. REMOVE ALL METAL WALL COPINGS/ METAL FASCIA/ CANT EDGES AND GRAVEL STOPS. REPLACE ALL METAL WITH NEW. CONTRACTOR SHALL VERIFY SIZES AND QUANTITIES.
6. INSTALL FLUID APPLIED ROOFING SYSTEM PER MANUFACTURER'S RECOMMENDATIONS.

ROOFING REVISED KEY NOTES:

1. CAPPED ROOF CURB (CRC) - REMOVE CAP, AND ROOF CURBS DOWN TO DECK. INFILL WITH LIKE MATERIAL. INSTALL NEW INSULATION TO MATCH ADJACENT AND PROVIDE NEW ROOF SYSTEM OVER THIS AREA.
2. PROVIDE AND INSTALL NEW RAILING SYSTEM (SEE SPECIFICATION & NEW WORK PLAN SHEET A12)
3. REPLACE ALL WET OR DAMAGED INSULATION. ALL OTHER INSULATION IS TO REMAIN IN PLACE.
4. CONNECT LIGHTNING PROTECTION SYSTEM TO EXISTING BUILDING GROUND SYSTEM. SEE SPECIFICATION FOR ADDITIONAL INFORMATION. CONTRACTOR IS TO VERIFY ALL QUANTITIES.

GENERAL REVISED ROOFING NOTES:

1. PROVIDE TAPERED INSULATION AS NOTED AND AS REQUIRED TO ACCOMPLISH POSITIVE SLOPE TO ALL DRAINS. MINIMUM INSULATION THICKNESS FOR TAPERED AREAS IS TO BE 1\"/>
2. ROOF SLOPE NOTED THUS:
→ PROVIDED BY SLOPED STRUCTURE
→ TI → PROVIDED BY TAPERED INSULATION
3. REFER TO SPECIFICATIONS FOR DESCRIPTION OF ROOF MEMBRANE SYSTEM AND REQUIREMENTS. PROVIDE SINGLE SOURCE SYSTEM. PROVIDE SYSTEM STANDARD DETAILS FOR ALL APPLICABLE FLASHINGS, OPENINGS, PENETRATION, TERMINATION, ETC., CONDITIONS.
4. PROVIDE ROOF WALKWAY. LOCATIONS ARE SHOWN ON ROOF PLAN
5. FOLLOW ALL MANUFACTURER'S INSTRUCTIONS REQUIRED TO PROVIDE A 20 YEAR WARRANTY.
6. CONTRACTOR SHALL VERIFY ALL DIMENSIONS, QUANTITIES, ROOFING MATERIALS AND EXISTING CONDITIONS PRIOR TO SUBMISSION OF BID.

ABBREVIATIONS:

EXV - EXHAUST VENT
PV - PLUMBING VENT
RD - ROOF DRAIN (SEE DETAIL)
RTU - ROOF TOP UNIT
SKY - SKYLIGHT (SEE DETAIL)
LRT - LIGHTNING ROD TERMINAL
WPC - WIRE CONDUIT ROOF PENETRATION
PC - PIPE CURB
RWP - ROOF WALKWAY PAVERS

**ROOF PLAN - REVISED,
NOTES & DETAILS**

SCALE: AS NOTED

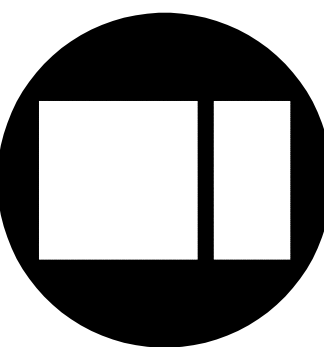
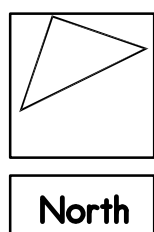

ISSUED FOR:	DATE	DRAWN	APPROVED	GT
		JSM		

DATE: 9-24-2021	PROJECT NUMBER	SHEET NUMBER	SHEET
	31126	A1.2	

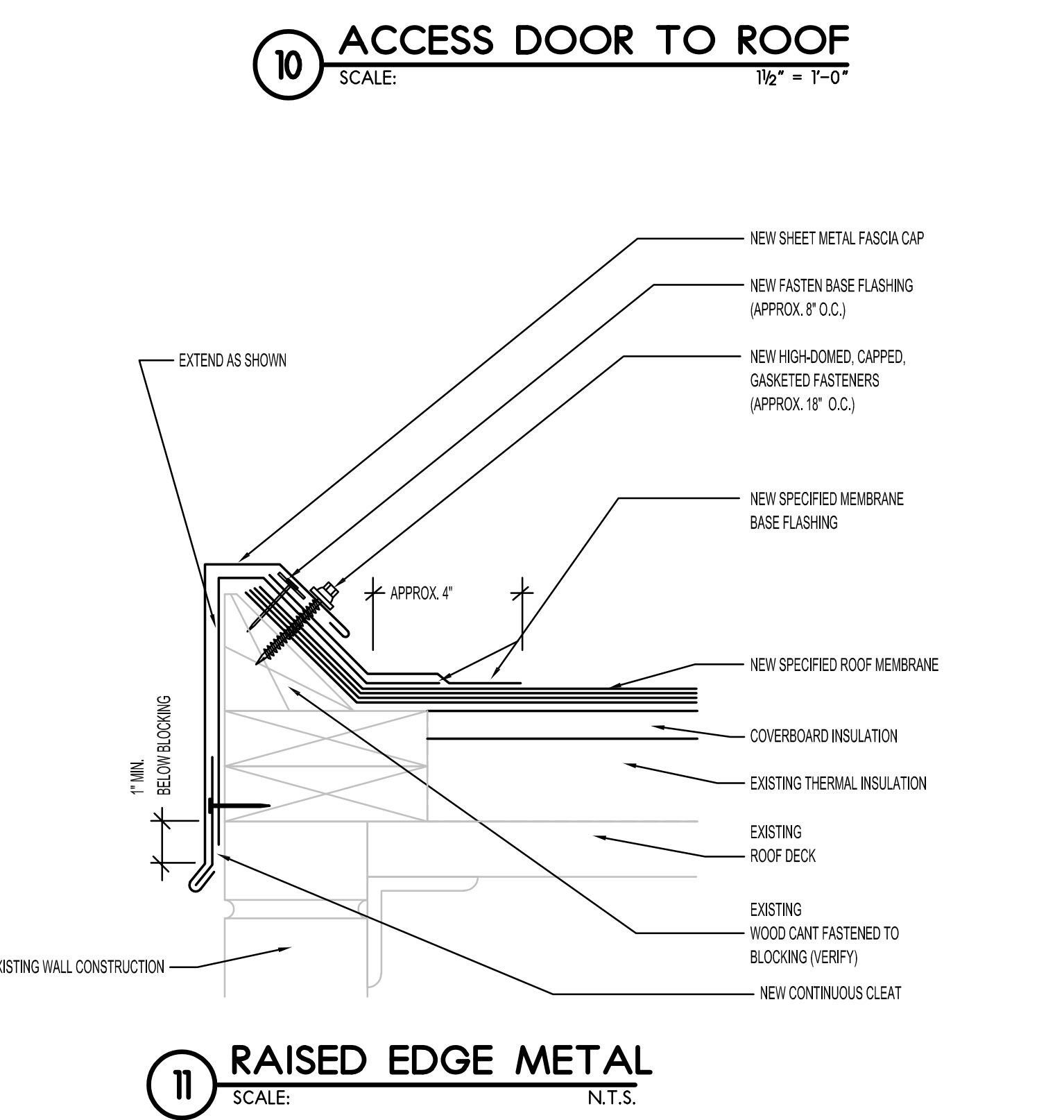
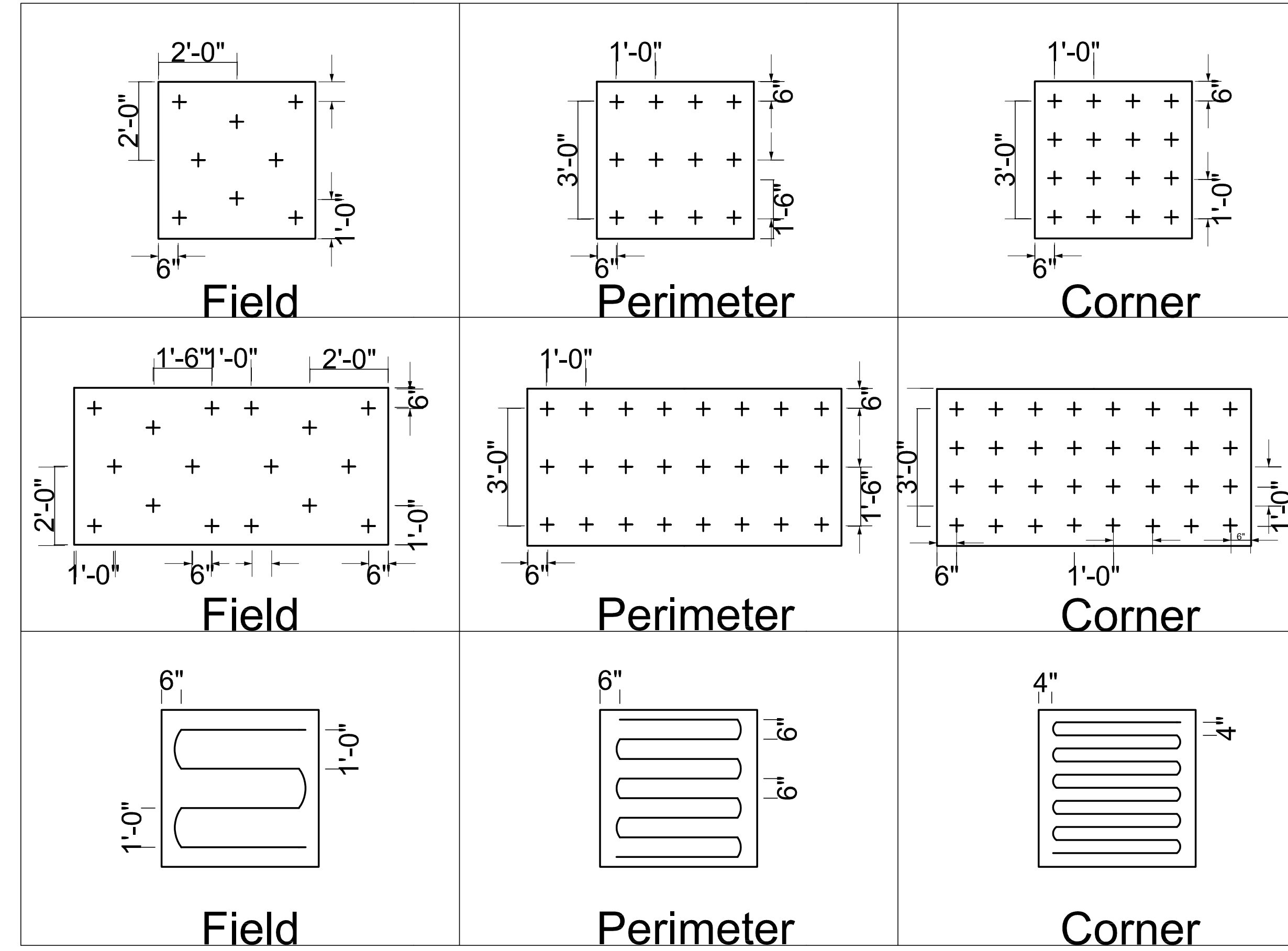
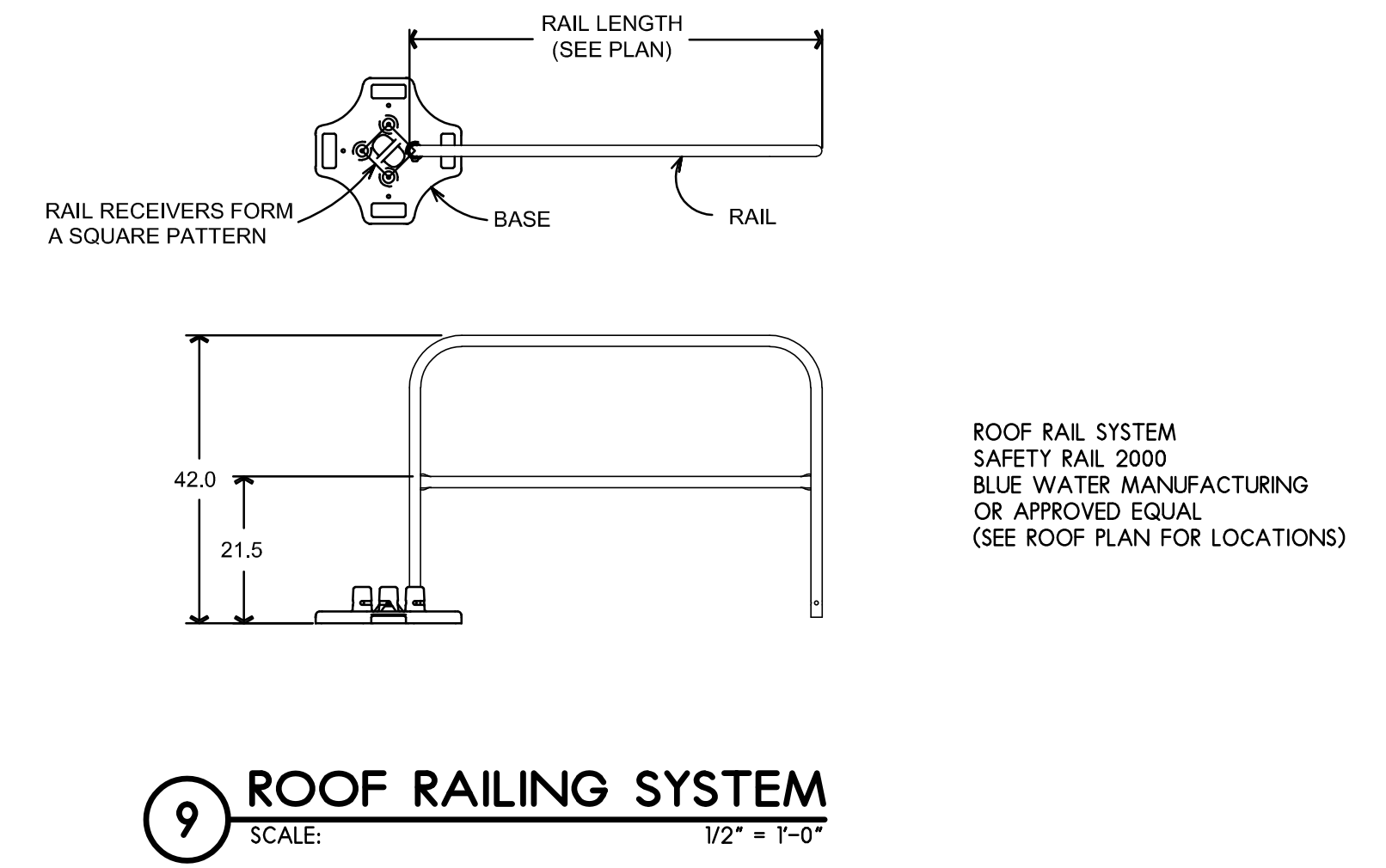
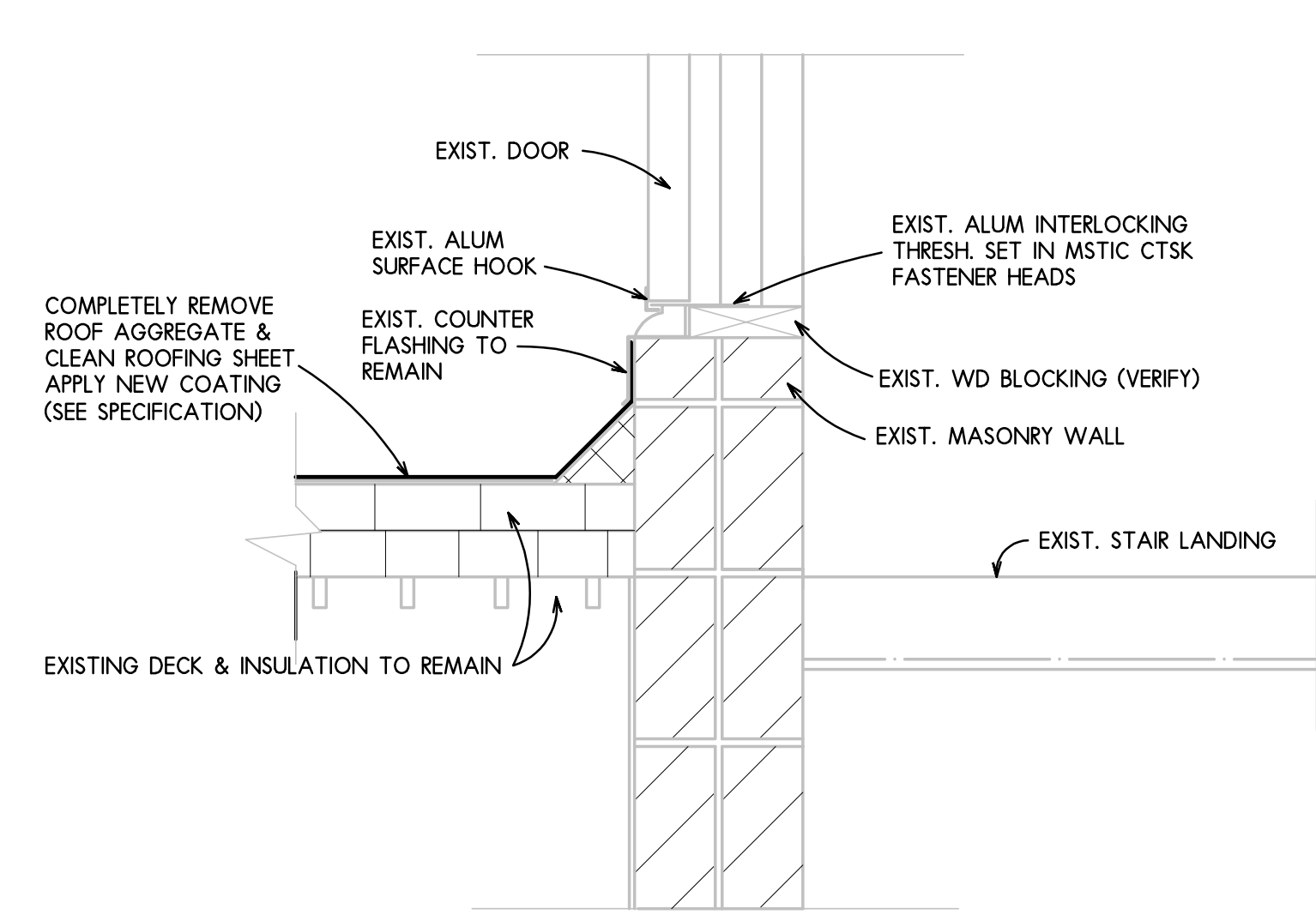
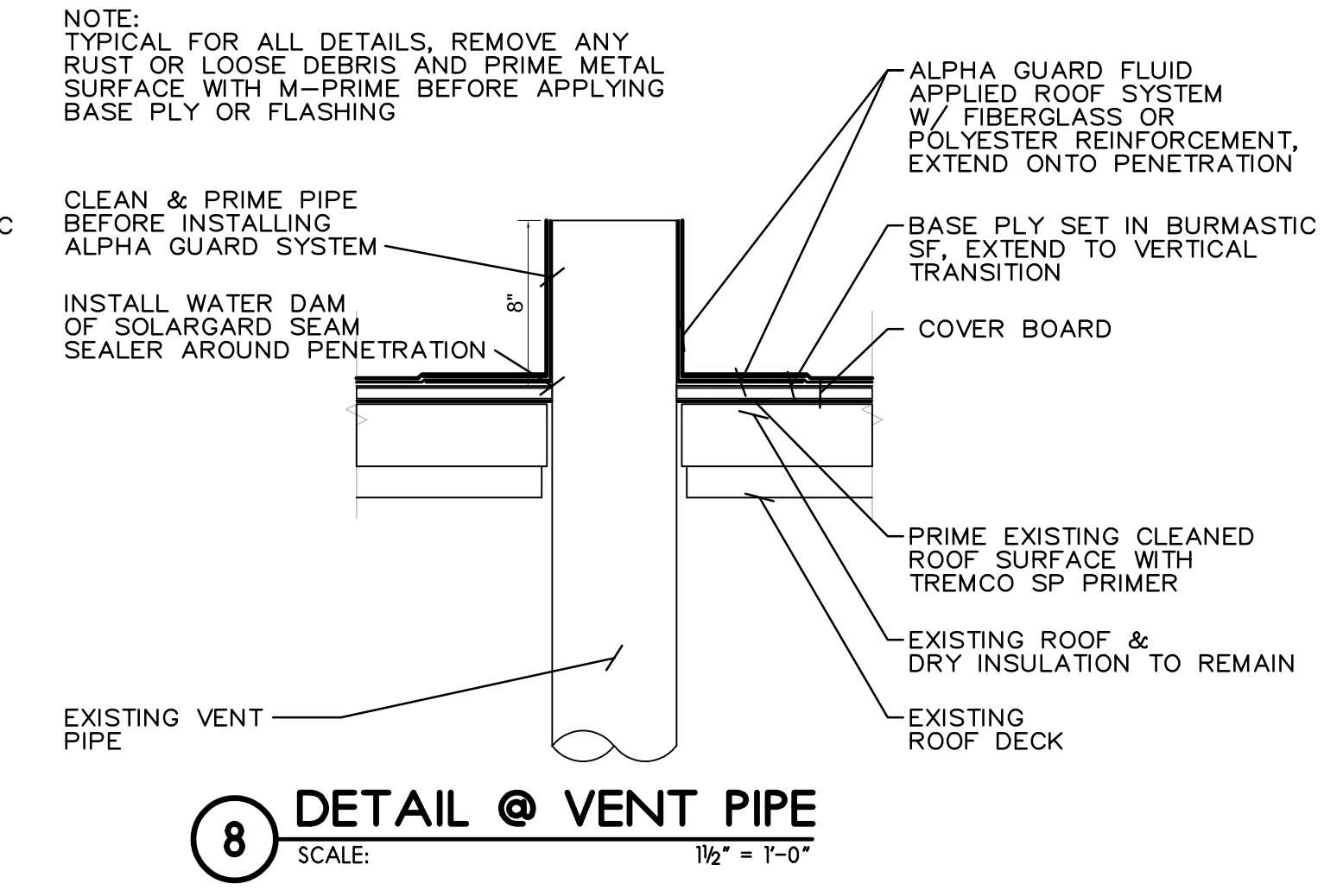
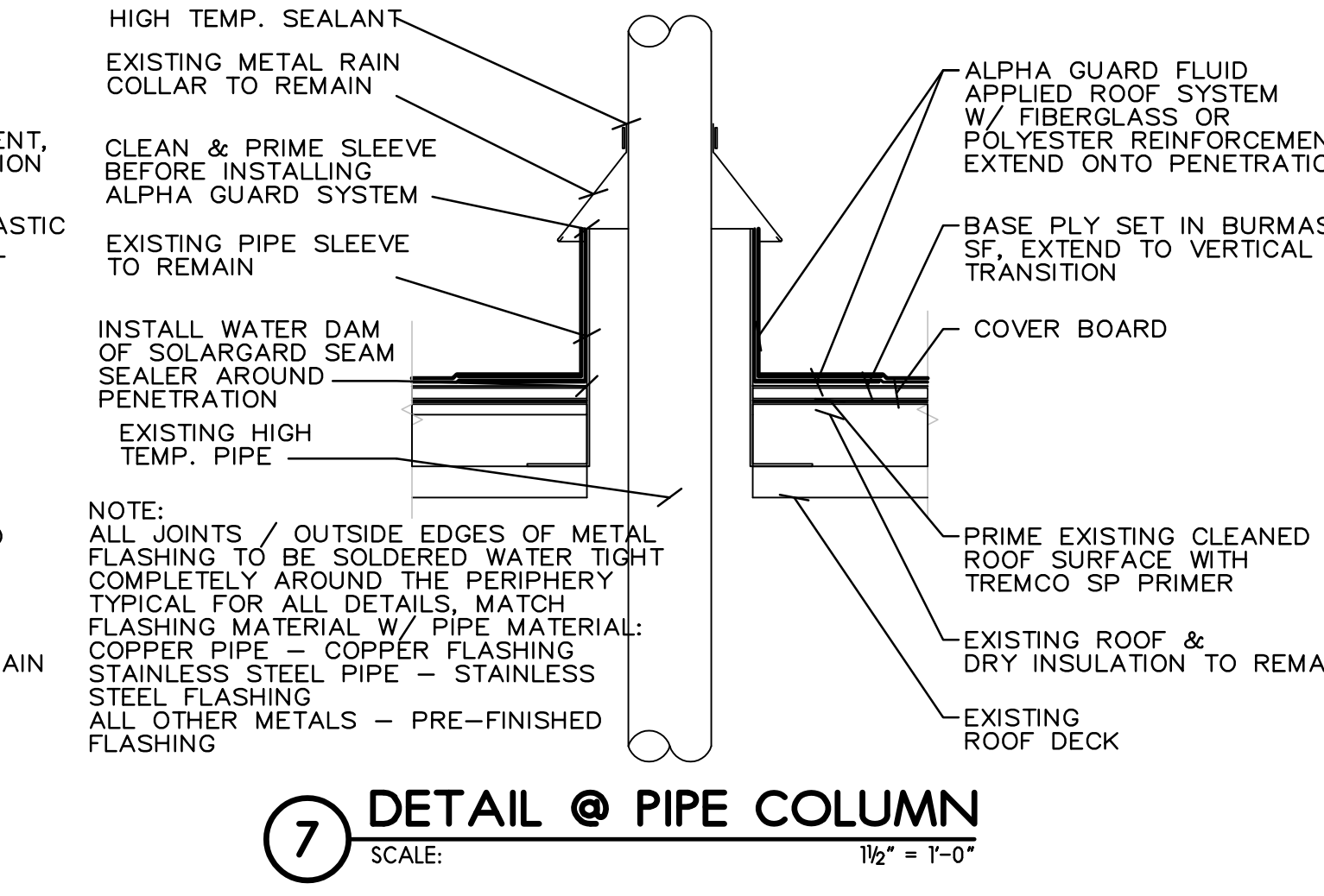
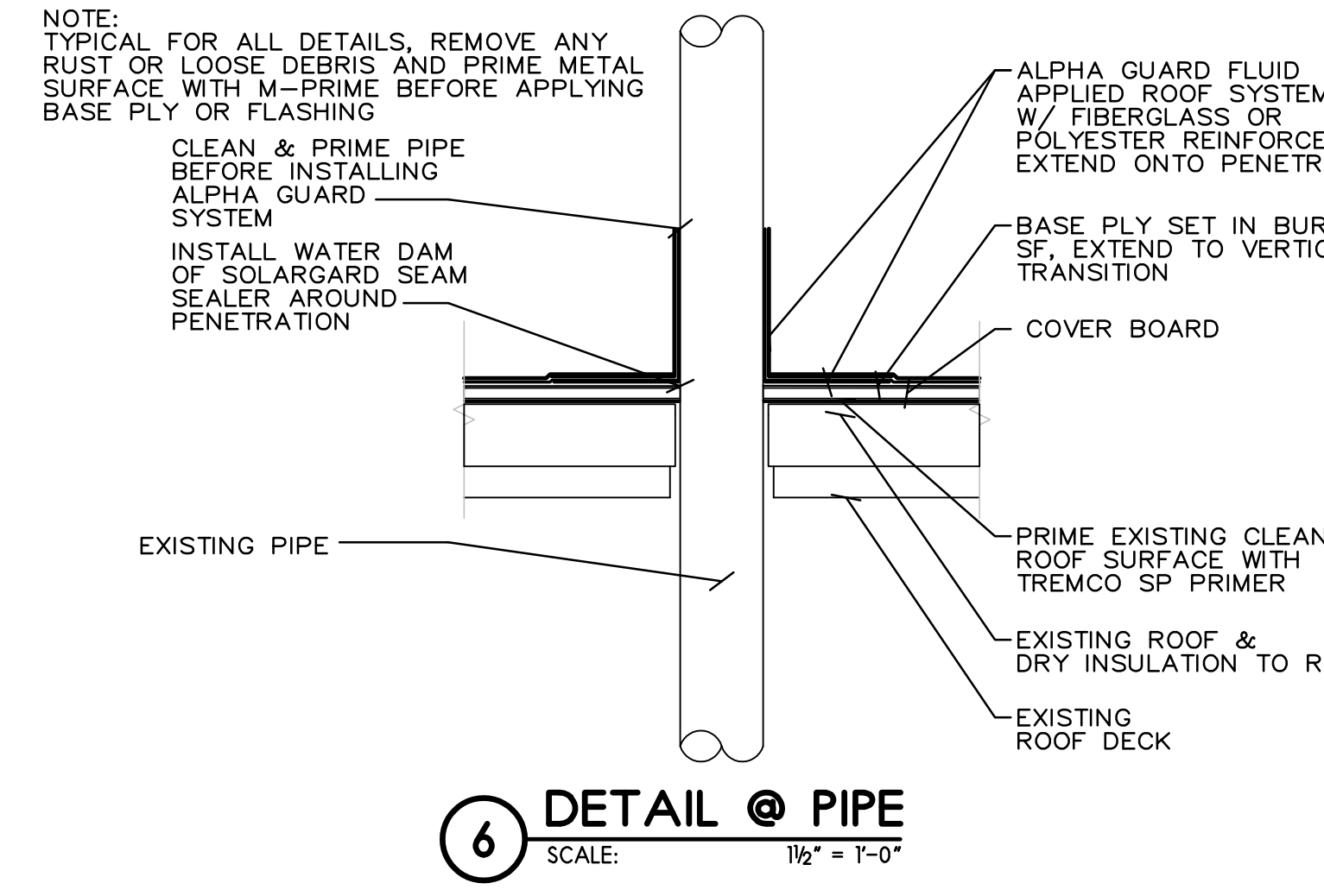
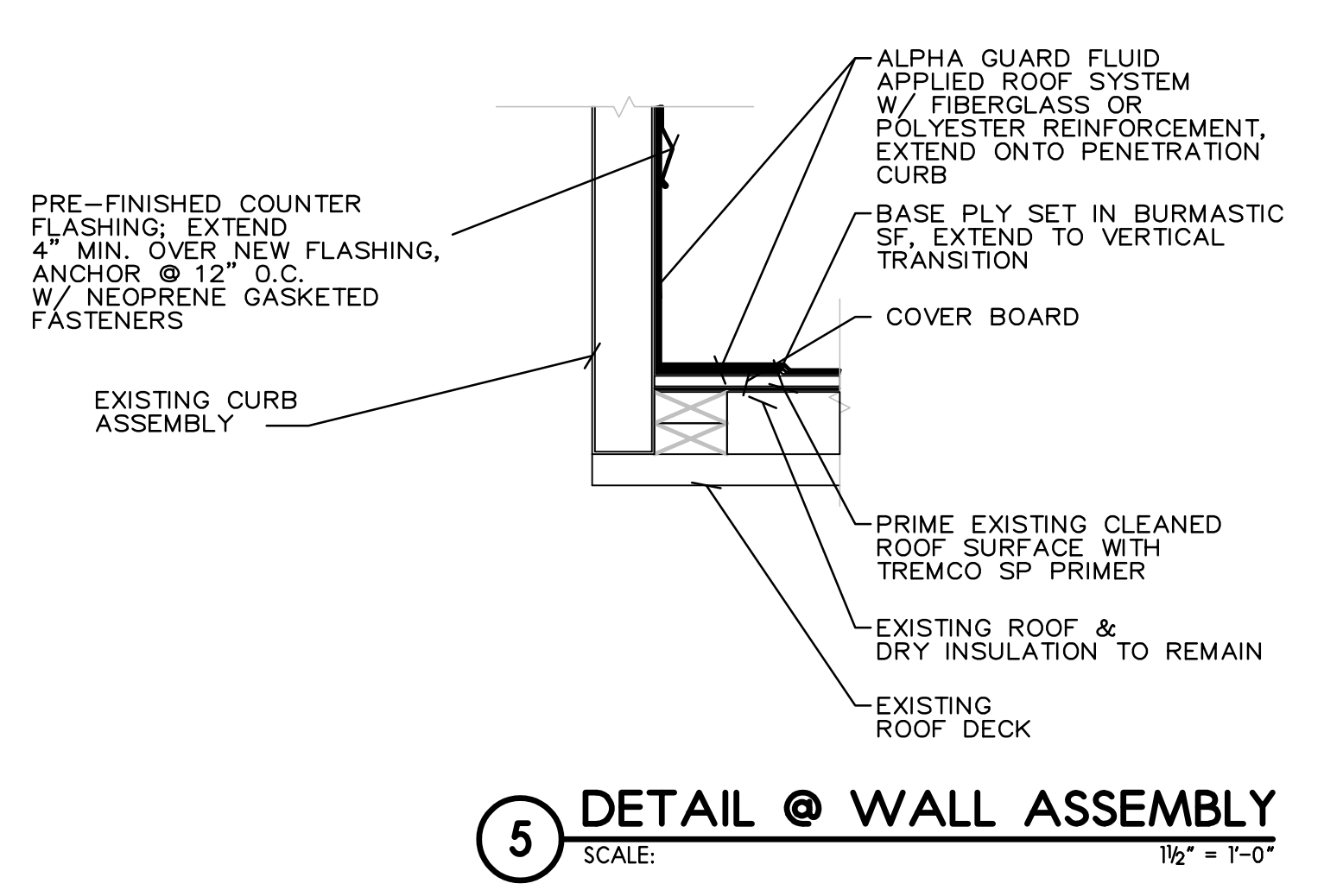
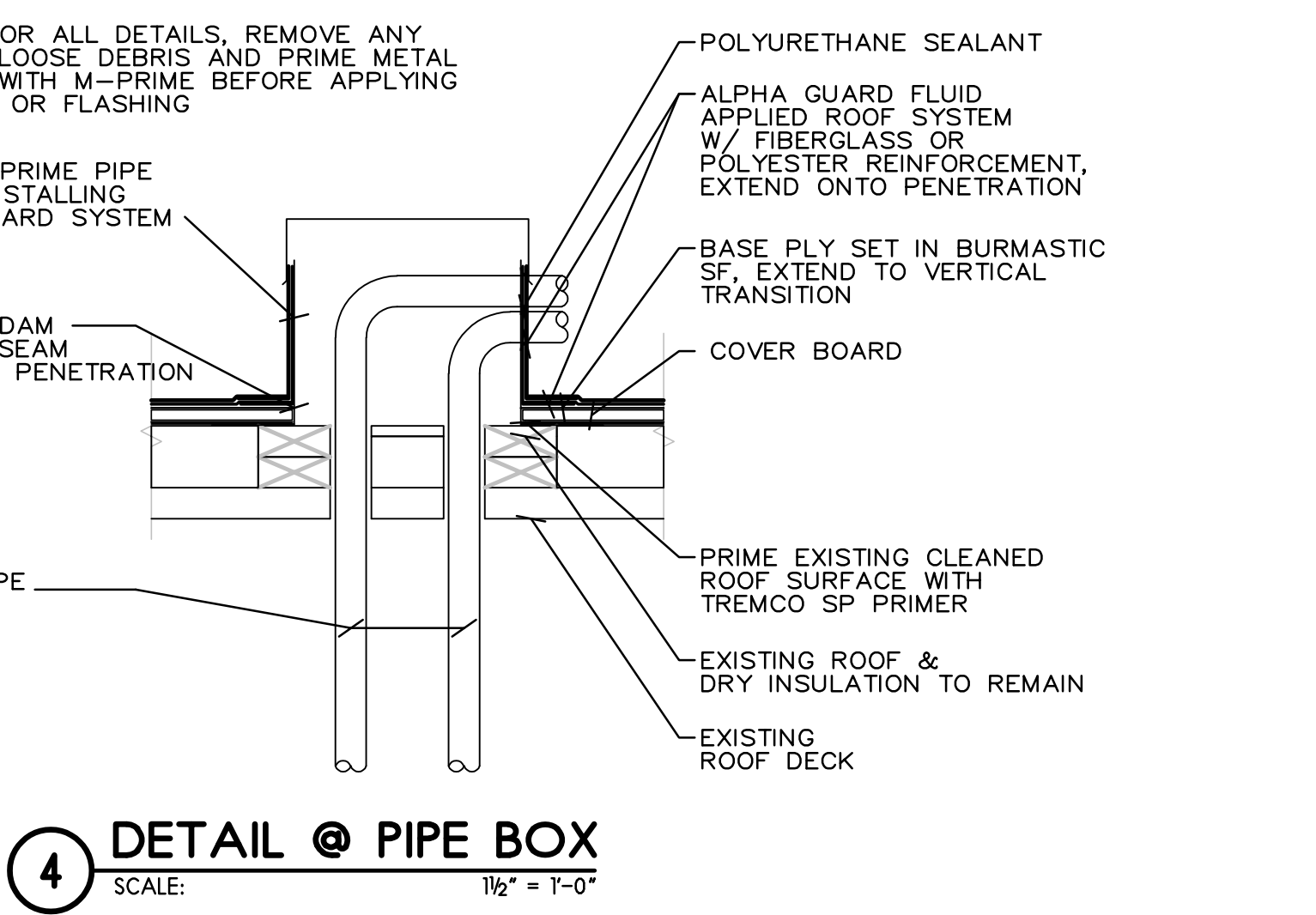
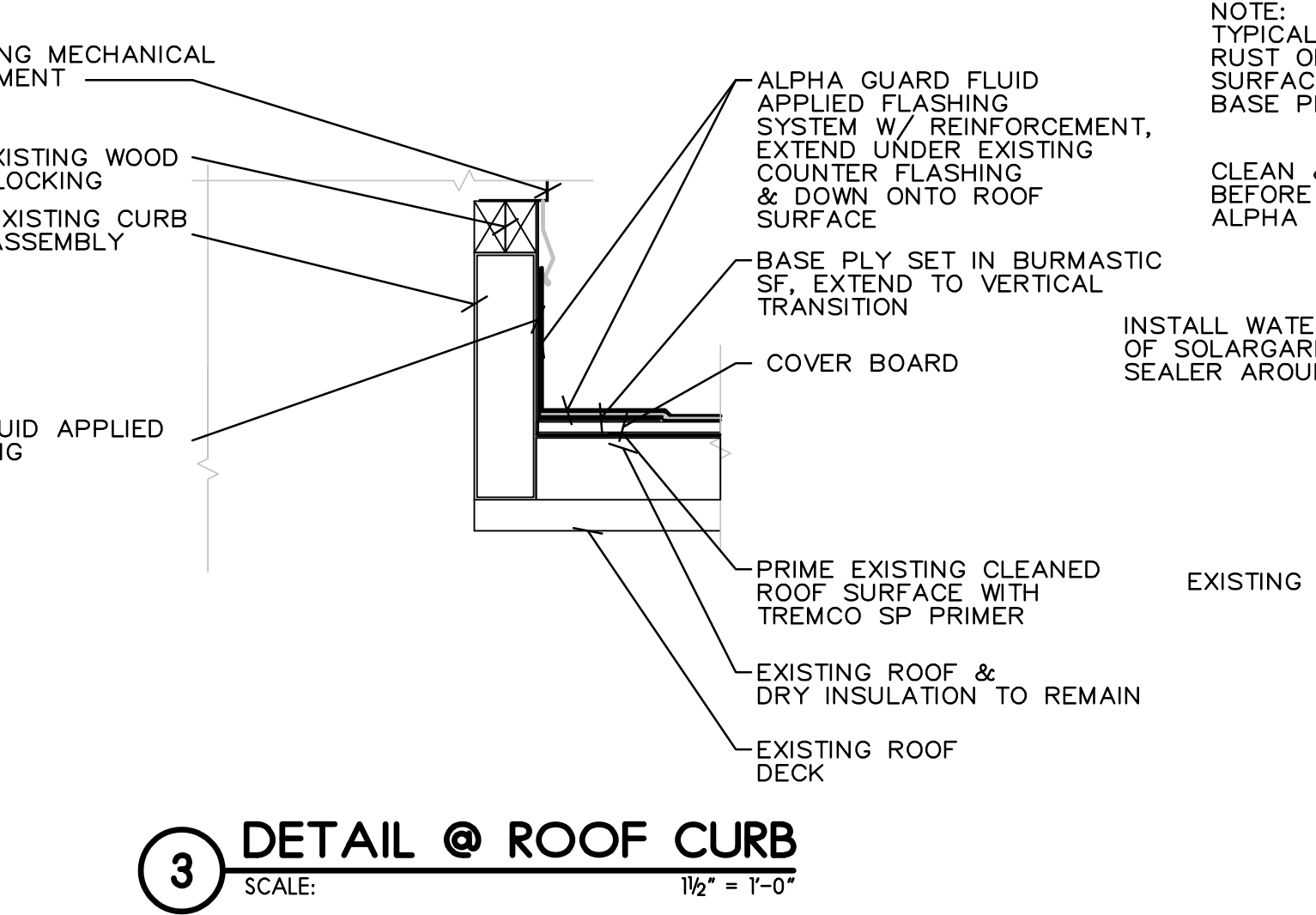
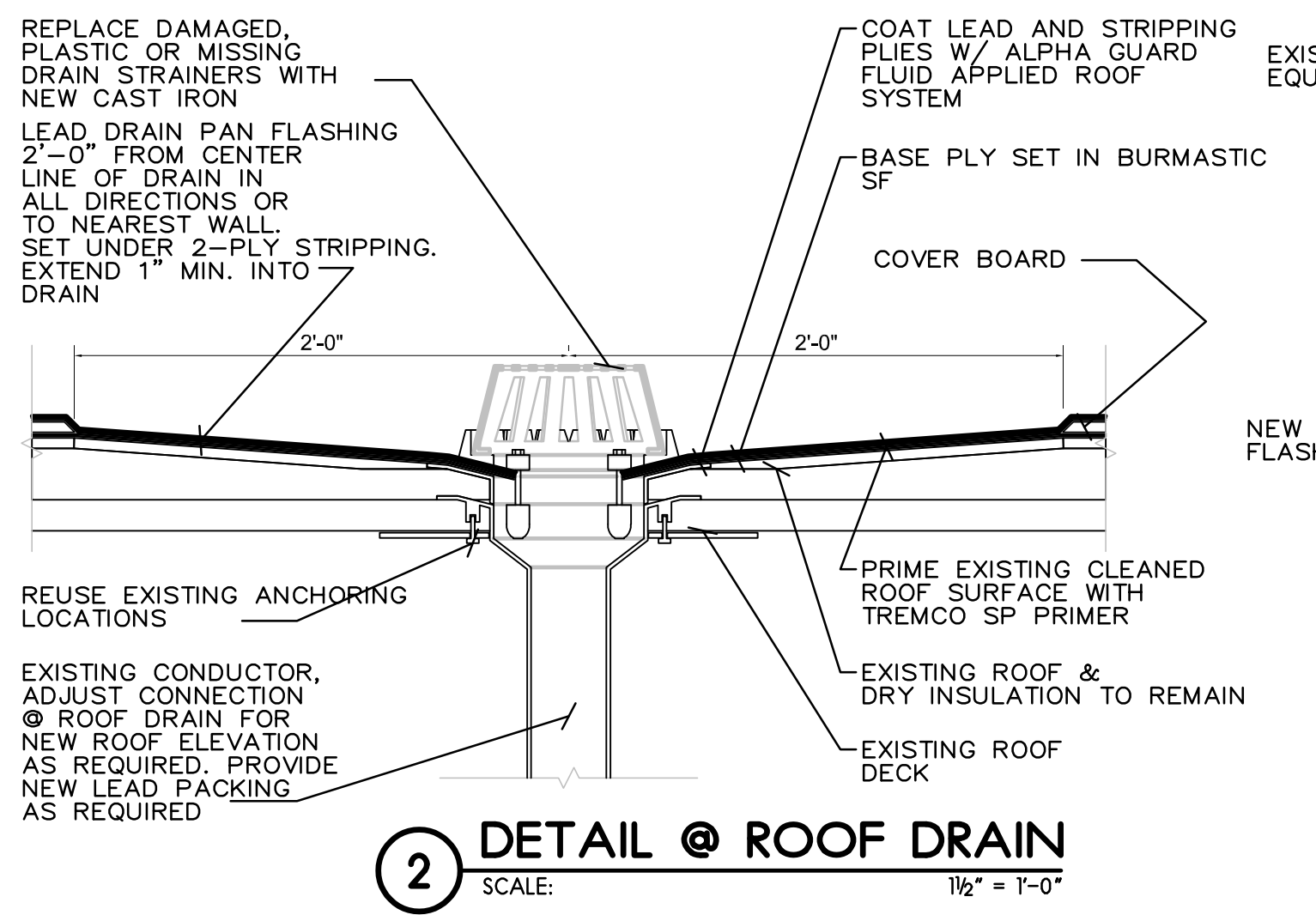
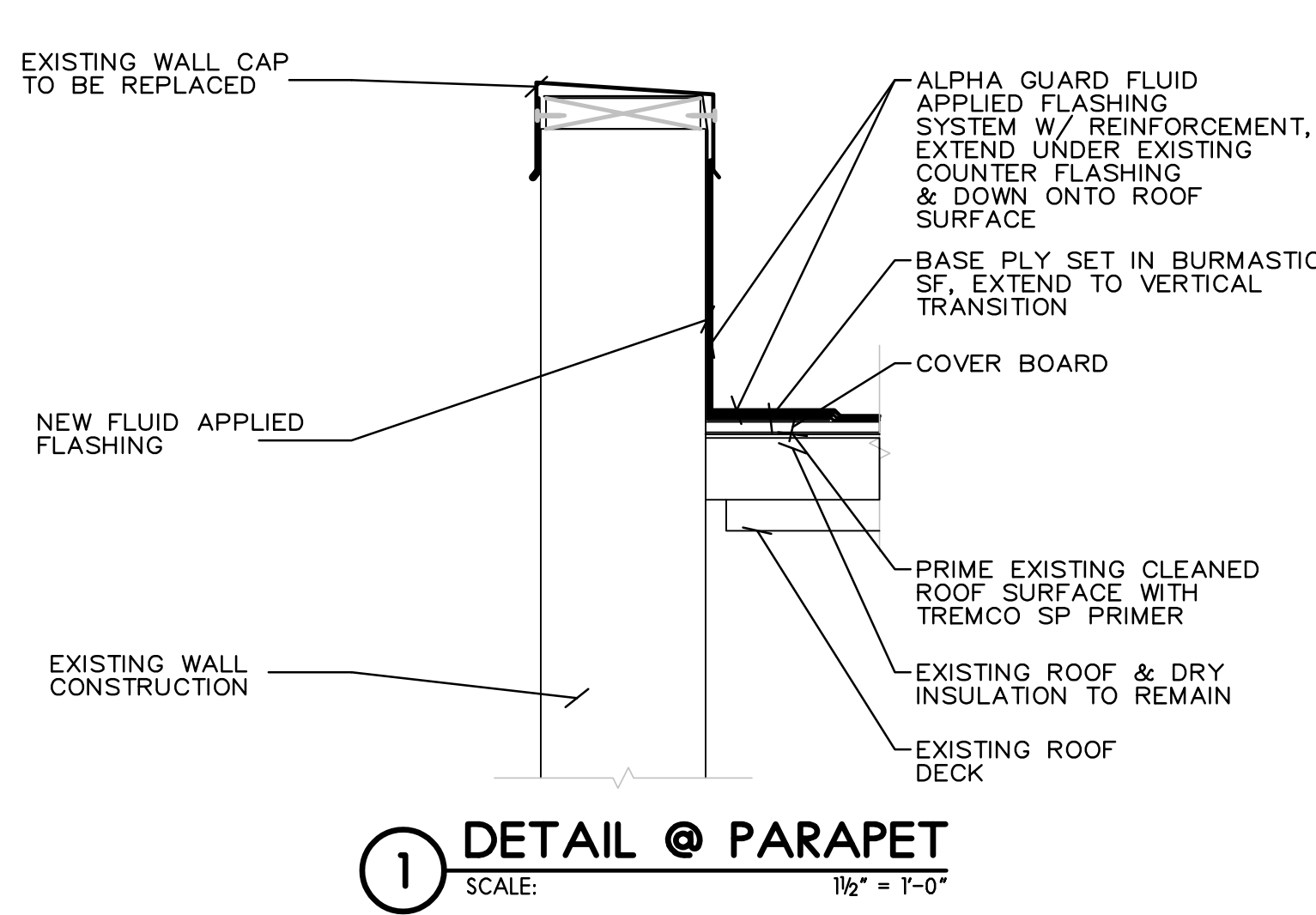

ROOF DETAILS

SCALE: AS NOTED

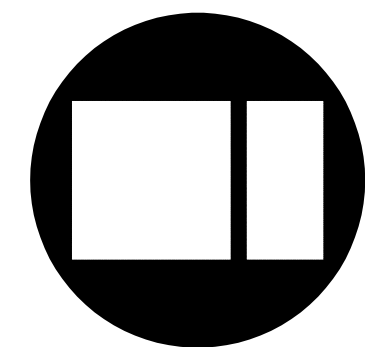

ROOF RESTORATION WINNEBAGO COUNTY COURTHOUSE 400 W. STATE STREET, ROCKFORD, ILLINOIS

COPYRIGHT 2021
All drawn and written information appearing herein shall not be duplicated, disclosed, or otherwise used without the written consent of Larson & Darby Group.

ISSUED FOR:	DATE:
DRAWN:	APPROVED:
JSM	GT

DATE: 9-24-2021	PROJECT NUMBER: 3126
SHEET NUMBER: A1.3	